



Test Report

Report No. A221046234210101

Page 1 of 7

Company Name DONGGUAN NINGXING TEXTILE CO., LTD
shown on Report

Address 16 TENGLING ROAD, CHASHAN TOWN, DONGGUAN CITY, GUANGDONG PROVINCE, CHINA

The following sample(s) and sample information was/were submitted and identified by/on the behalf of the applicant

Sample Name School bag
Sample Received Date Nov. 22, 2021
Testing Period Nov. 22, 2021 to Dec. 3, 2021

Test Requested As specified by client, to test Phthalates in the submitted sample(s).

Test Method

Tested Item(s)	Test Method	Measured Equipment(s)
Phthalates	Refer to EN 14372:2004(E)	GC-MS

Test Result(s) Please refer to the following page(s).

Tested by

Lily Li

Reviewed by

Jori Xia

Approved by

Helen Liu

Date

Feb. 24, 2022

Helen Liu

Lab Authorized Signatory

No. R450141340



Centre Testing International Group Co., Ltd.

Inspection & Testing Services

CTI Building, Xing Dong Community, Xin'an Sub-district, Bao'an District, Shenzhen City, Guangdong Province, P.R. China

Test Report

Report No. A221046234210101

Page 2 of 7

Test Result(s)

Tested Item(s)	Result			MDL
	001	002	003	
Phthalates				
Dibutyl phthalate(DBP) CAS#:84-74-2	N.D.	N.D.	N.D.	50 mg/kg
Bis(2-ethyl(hexyl)phthalate)(DEHP) CAS#:117-81-7	N.D.	N.D.	N.D.	50 mg/kg
Benzyl butyl phthalate(BBP) CAS#:85-68-7	N.D.	N.D.	N.D.	50 mg/kg
Diisobutyl phthalate (DIBP) CAS#:84-69-5	N.D.	N.D.	N.D.	50 mg/kg
^① 1,2-Benzenedicarboxylic acid, di-C6-8-branched alkyl esters, C7-rich CAS#:71888-89-6	N.D.	N.D.	N.D.	100 mg/kg
Bis(2-methoxyethyl) phthalate CAS#:117-82-8	N.D.	N.D.	N.D.	50 mg/kg
Diisopentylphthalate(DIPP) CAS#:605-50-5	N.D.	N.D.	N.D.	50 mg/kg
n-pentyl-isopentylphthalate CAS#:776297-69-9	N.D.	N.D.	N.D.	50 mg/kg
Dipentyl phthalate (DPP) CAS#:131-18-0	N.D.	N.D.	N.D.	100 mg/kg
Dihexyl phthalate CAS#:84-75-3	N.D.	N.D.	N.D.	100 mg/kg
^① 1,2-Benzenedicarboxylic acid, dihexyl ester, branched and linear CAS#:68515-50-4	N.D.	N.D.	N.D.	100 mg/kg
Dicyclohexyl phthalate (DCHP) CAS#:84-61-7	N.D.	N.D.	N.D.	100 mg/kg
Diisohexyl phthalate CAS#:71850-09-4	N.D.	N.D.	N.D.	100 mg/kg

Tested Item(s)	Result			MDL
	004	005	006	
Phthalates				
Dibutyl phthalate(DBP) CAS#:84-74-2	N.D.	N.D.	N.D.	50 mg/kg
Bis(2-ethyl(hexyl)phthalate)(DEHP) CAS#:117-81-7	N.D.	N.D.	N.D.	50 mg/kg
Benzyl butyl phthalate(BBP) CAS#:85-68-7	N.D.	N.D.	N.D.	50 mg/kg
Diisobutyl phthalate (DIBP) CAS#:84-69-5	N.D.	N.D.	N.D.	50 mg/kg
^① 1,2-Benzenedicarboxylic acid, di-C6-8-branched alkyl esters, C7-rich CAS#:71888-89-6	N.D.	N.D.	N.D.	100 mg/kg
Bis(2-methoxyethyl) phthalate CAS#:117-82-8	N.D.	N.D.	N.D.	50 mg/kg
Diisopentylphthalate(DIPP) CAS#:605-50-5	N.D.	N.D.	N.D.	50 mg/kg
n-pentyl-isopentylphthalate CAS#:776297-69-9	N.D.	N.D.	N.D.	50 mg/kg
Dipentyl phthalate (DPP) CAS#:131-18-0	N.D.	N.D.	N.D.	100 mg/kg
Dihexyl phthalate CAS#:84-75-3	N.D.	N.D.	N.D.	100 mg/kg
^① 1,2-Benzenedicarboxylic acid, dihexyl ester, branched and linear CAS#:68515-50-4	N.D.	N.D.	N.D.	100 mg/kg
Dicyclohexyl phthalate (DCHP) CAS#:84-61-7	N.D.	N.D.	N.D.	100 mg/kg
Diisohexyl phthalate CAS#:71850-09-4	N.D.	N.D.	N.D.	100 mg/kg

Test Report

Report No. A221046234210101

Page 3 of 7

Sample/Part Description

Sample No.	Article No.
001	1+2+3+4+5+6+7+8+9
002	10+11+12+13+14+15+16+17+18
003	19+20+21+22+23+24+25+26+27
004	28+29+30+31+32+33+34+35+36
005	37+38+39+40+41+42+43+44+45
006	46+47+48

Article No.	Sample/Part Description
1	Transparent plastic with blue printing
2	Yellow plastic
3	Yellow plastic
4	Blue woven belt
5	Gray rubber
6	Pink fabric
7	White cloth with color printing
8	Pink velcro(hook)
9	Pink velcro(loop)
10	Pink plastic
11	Pink woven belt
12	White woven label with black printing
13	Pink thread
14	Beige rubber with green print
15	Green braided rope
16	Bright silver plastic
17	Yellow thread
18	Black fabric
19	Black plastic
20	Transparent plastic
21	Transparent plastic
22	Pink plastic
23	Pink plastic
24	Yellow woven belt
25	Yellow thread
26	Yellow rubber
27	Gray fabric
28	Pink fabric
29	Pink braided rope
30	Yellow foam

Test Report

Report No. A221046234210101

Page 4 of 7

Article No.	Sample/Part Description
31	Pink plush
32	Gray foam
33	Black plush
34	Pink fabric
35	Black plastic
36	Silver / black plastic
37	White woven label with black printing
38	White foam
39	Purple fabric
40	White fabric
41	Silvery/transparent plastic
42	Pink thread
43	Black plastic
44	Black plastic
45	Black woven belt
46	Black rubber
47	Transparent plastic with black printing
48	Beige solid

Remark: -As specified by client, the test was conducted by mixing several samples together. The result(s) shown on this report may be different from the content of any homogeneous material.

-MDL = Method Detection Limit

-N.D. = Not Detected (<MDL)

-mg/kg = ppm = parts per million

-^①: In view of the substances are established as UVCB substances (substances of unknown or variable composition, complex reaction products or biological materials) consisting of different and variable constituents, the test results are calculated based on the main constituents of the representative compounds for substances.

-The test result(s) is(are) presented in reference to the result(s) that reported in A2210462342101.

Test Process

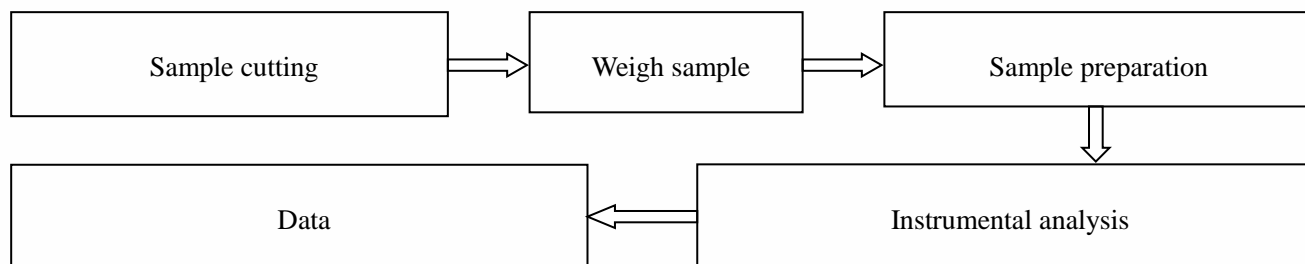

Test Report

Report No. A221046234210101

Page 5 of 7

Photo(s) of the sample(s)



Test Report

Report No. A221046234210101

Page 6 of 7

Photo(s) of the sample(s)

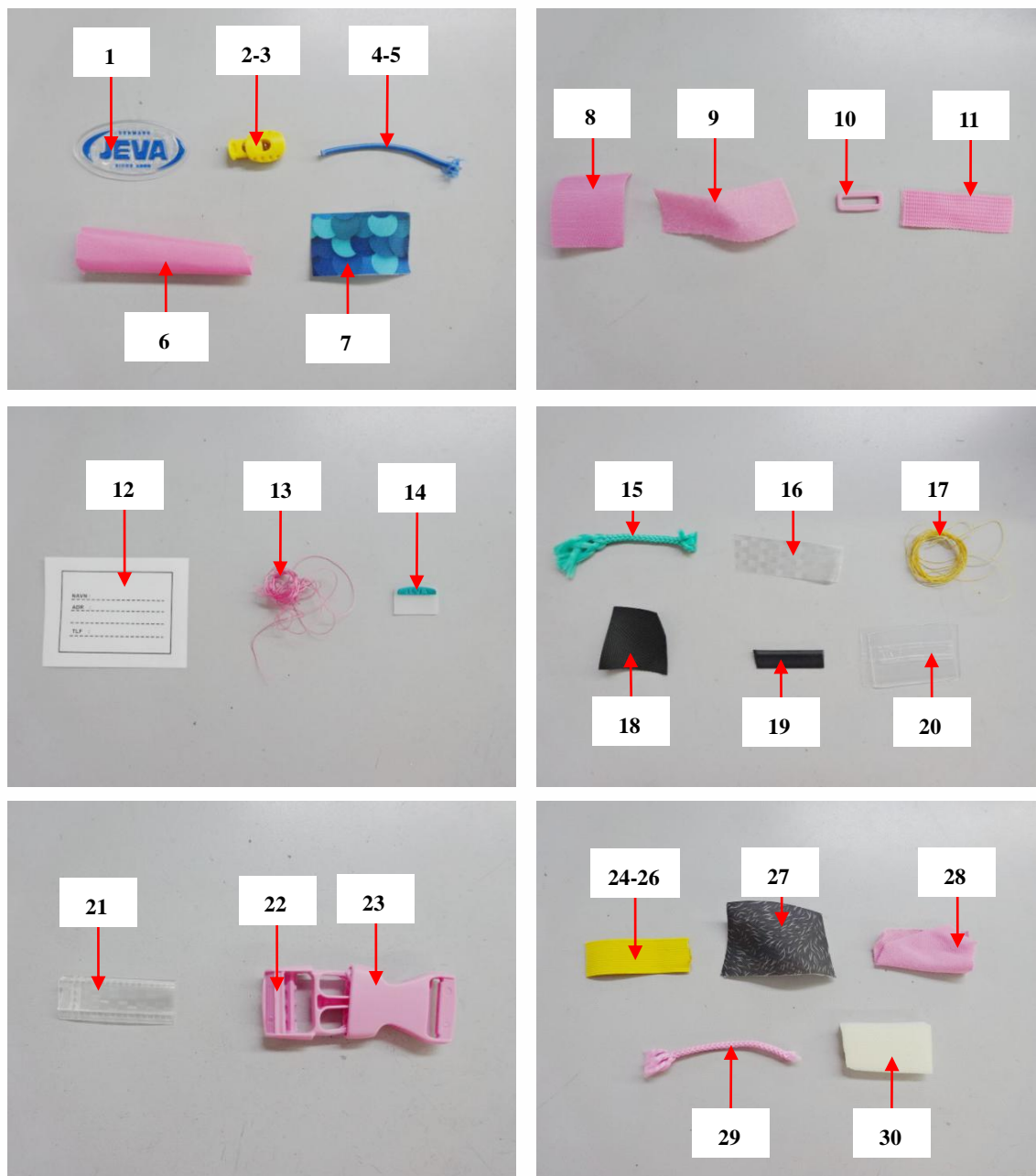

有限公司

Test Report

Report No. A221046234210101

Page 7 of 7

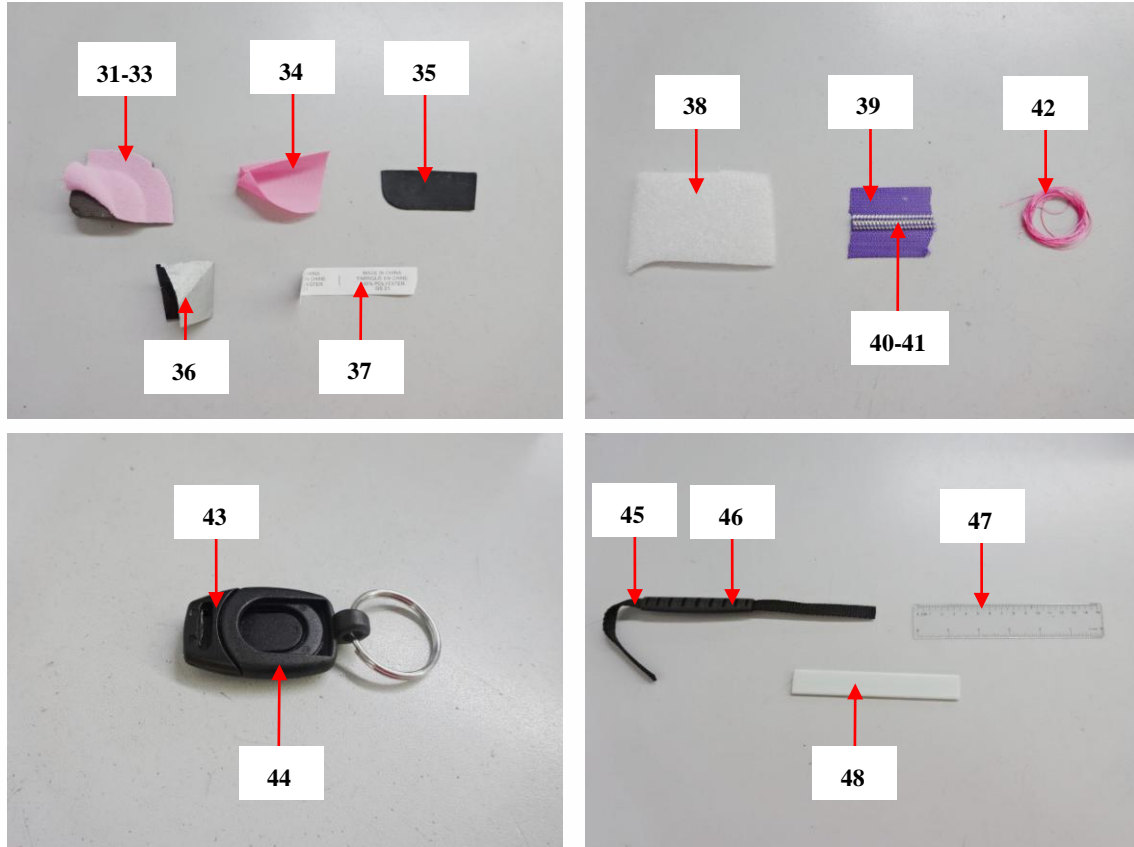

Statement:

1. This report is considered invalid without approved signature, special seal and the seal on the perforation;
2. The Company Name shown on Report and Address, the sample(s) and sample information was/were provided by the applicant who should be responsible for the authenticity which CTI hasn't verified;
3. The result(s) shown in this report refer(s) only to the sample(s) tested;
4. Without written approval of CTI, this report can't be reproduced except in full;
5. In case of any discrepancy between the English version and Chinese version of the testing reports (if generated), the Chinese version shall prevail.

*** End of Report ***